



SSMB



Aliner Industries, Inc.

No. 32, Lane 387, Min-an Rd., Sinjhuang City,
Taipei County 24256, Taiwan

Tel : +886-2-2205-5791
E-mail : sales@aliner.com.tw

Fax : +886-2-2203-8052 / 2205-5628
<http://www.aliner.com.tw>

SSMB - Description

Aliner SSMB connector, designed for use where small, light-weight interconnection is needed, has a snap-on coupling and is a miniaturized version of SMB connector.

Interface Mating Dimensions

MALE :

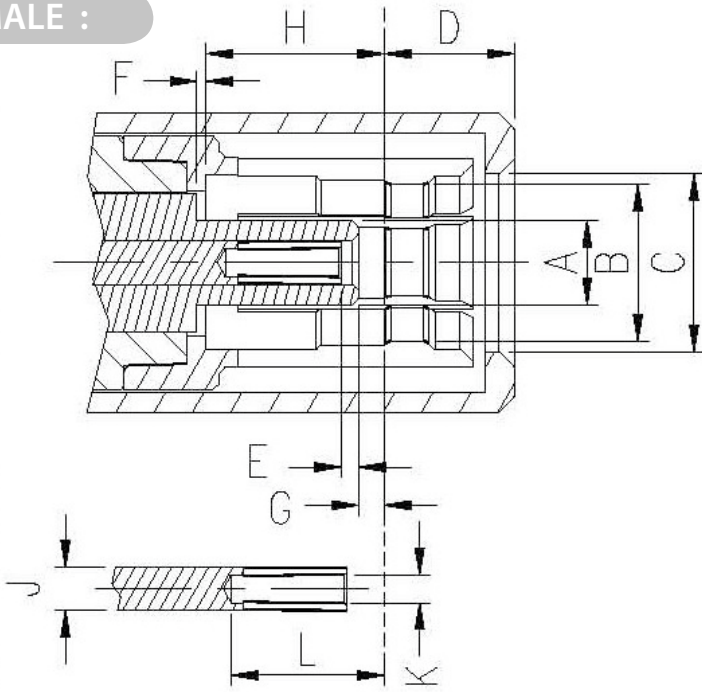

LTR.	Millimeters / Inches			
	MINIMUM		MAXIMUM	
A -	Ø 1.30	Ø .051	Ø 1.35	Ø .051
B -	Ø 2.46	Ø .097	Ø 2.51	Ø .097
C -	Ø 2.74	Ø .108	Ø 3.21	Ø .108
D -			2.26	.089
E -	0.00	.000	0.20	.008
F -	0.00	.000	0.20	.008
G -	0.43	.017	0.53	.021
H -	2.74	.108	2.79	.110
I -	Ø 2.11 Ø .083 nominal			
J -	Ø 0.63	Ø .025	Ø 0.68	Ø .027
K -	Ø 0.45	Ø .018	Ø 0.50	Ø .020
L -	2.46	.097		

FEMALE :

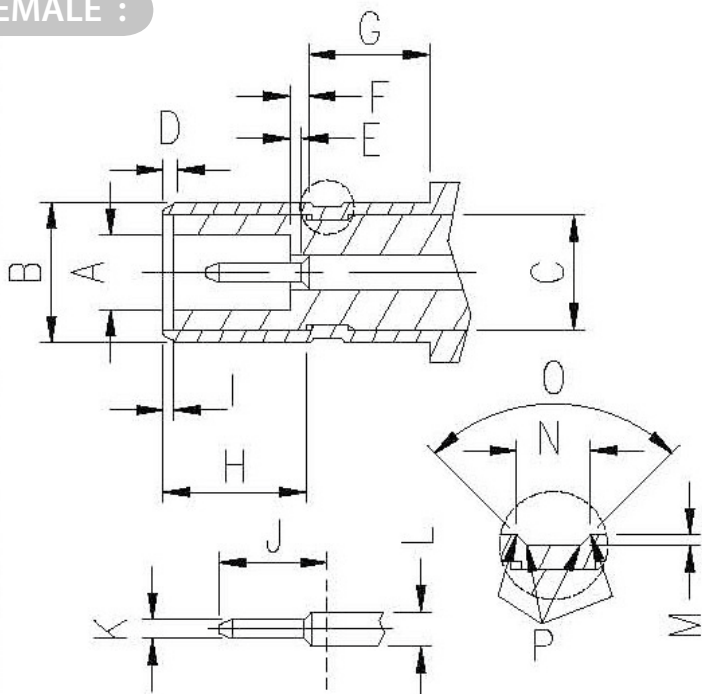

LTR.	Millimeters / Inches			
	MINIMUM		MAXIMUM	
A -	Ø 1.37	Ø .054	Ø 1.42	Ø .056
B -	Ø 2.62	Ø .103	Ø 2.68	Ø .106
C -	Ø 2.11 Ø .083 nominal			
D -	0.00	.000	0.50	.020
E -	0.00	.000	0.13	.005
F -	0.46	.018	0.56	.022
G -	2.29	.090		
H -	2.69	.106	2.74	.108
I -	0.00	.000	0.13	.005
J -			2.44	.096
K -	Ø 0.36	Ø .014	Ø 0.40	Ø .016
L -	Ø 0.63	Ø .025	Ø 0.68	Ø .027
M -	0.05	.002	0.15	.006
N -	0.64	.025	0.74	.029
O -	90° nominal			
P -	R0.08 nominal			



Technical Data

Material / Finish :

	Material	Finish
Connector body	Brass per (QQ-B-626 or JIS-C3604B)	Nickel or gold plating
Center contact male	Brass per (QQ-B-626 or JIS-C3604B)	Gold plating
Center contact female	Beryllium copper per (QQ-C-530 or JIS-C1730) or Phosphor bronze per (QQ-B-750 or JIS-C5441B)	Gold plating
Insulator	PTFE	None
Crimp ferrule	Annealed copper	Same as body
Gasket	Silicone rubber	None

Electrical :

Nominal impedance	50 Ω
Frequency up to	3.0 GHz
VSWR	1.25 max.@1GHz for straight connector 1.5 max. @1GHz for right angle connector
Working voltage	250 Volts rms.
Dielectric withstanding voltage	500 Volts rms.
Insulation resistance	500 MΩ min.
Contact resistance	center conductor 6.0 mΩ initial. outer conductor 1.5 mΩ.

Mechanical & Environmental :

Mating	Snap on coupling
Cable retention	3.0 kgf typical
Durability	≥ 500 cycles
Engagement force	3.0 kgf max.
Disengagement force	0.5 kgf min.
Temperature range	-55 °C to +155 °C
Vibration	Per MIL-STD-202 Method 204 Test Condition D
Corrosion	Per MIL-STD-202 Method 101 Test Condition B

Straight Jack(male contact)

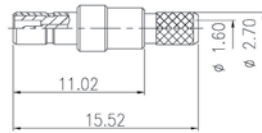

Aliner P/N	Impedance	Plating	Packaging	Cable Type	Note
22-301B1-B	50	Gold	Bulk	RD-316	Standard
22-301B0-B	50	Gold	Bulk	RG-174/U;RG-188 A/U;RG-316/U	Standard
22-301A0-B	50	Gold	Bulk	RG-178 B/U;RG-196 A/U	Standard

Straight Plug(female contact)

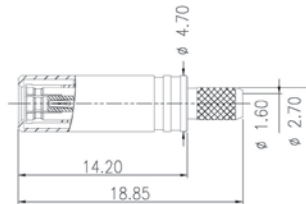

Aliner P/N	Impedance	Plating	Packaging	Cable Type	Note
22-101A1-B	50	Gold	Bulk	RD-316	Standard
22-101A0-B	50	Gold	Bulk	RG-174/U;RG-188 A/U;RG-316/U	Standard

Straight Plug(female contact)

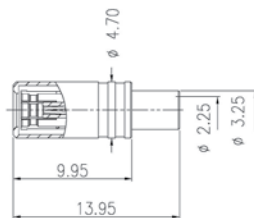

Aliner P/N	Impedance	Plating	Packaging	Cable Type	Note
22-101B0-B	50	Gold	Bulk	.047 semi-rigid	Standard
22-101C0-B	50	Gold	Bulk	.085 semi-rigid	Standard
22-101A2-B	50	Gold	Bulk	RG-178 B/U;RG-196 A/U	Standard

Right Angle Jack(male contact)



Aliner P/N	Impedance	Plating	Packaging	Cable Type	Note
22-109A0-B	50	Gold	Bulk	RG-174/U;RG-188 A/U;RG-316/U	Standard

Right Angle Plug(female contact)

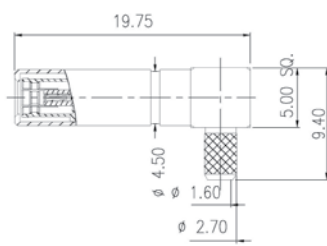

Aliner P/N	Impedance	Plating	Packaging	Cable Type	Note
22-209A0-B	50	Gold	Bulk	RG-174/U;RG-188 A/U;RG-316/U	Standard
22-209B0-B	50	Gold	Bulk	RG-178 B/U;RG-196 A/U	Standard

Right Angle Plug(female contact)

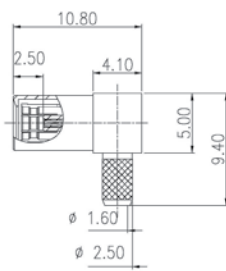

Aliner P/N	Impedance	Plating	Packaging	Cable Type	Note
22-209C0-B	50	Gold	Bulk	RG-174/U;RG-188 A/U;RG-316/U	Standard
22-209G0-B	50	Gold	Bulk	RG-178 B/U;RG-196 A/U	Standard



Right Angle Plug(female contact)

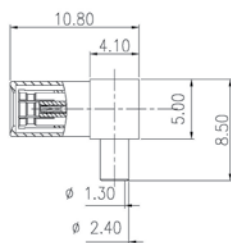

Aliner P/N	Impedance	Plating	Packaging	Cable Type	Note
22-209E0-B	50	Gold	Bulk	.047 semi-rigid	Standard
22-209D0-B	50	Gold	Bulk	.085 semi-rigid	Standard



Straight Jack(male contact)

PCB MOUNT

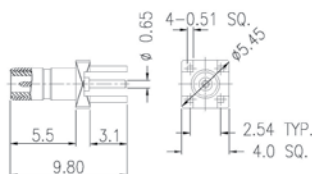

Aliner P/N	Impedance	Plating	Packaging	Mounting Pattern	Note
22-002A0-T	50	Gold	Tray	B02	Standard

Straight Plug(female contact)

PCB MOUNT

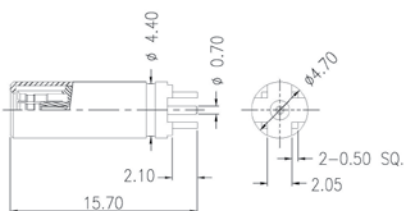

Aliner P/N	Impedance	Plating	Packaging	Mounting Pattern	Note
22-003A0-T	50	Gold	Tray	B02	Standard



Straight Plug(female contact)

PCB MOUNT

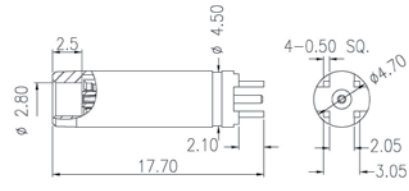

Aliner P/N	Impedance	Plating	Packaging	Mounting Pattern	Note
22-003B0-T	50	Gold	Tray	B02	Standard

Straight Plug(female contact)

PCB MOUNT

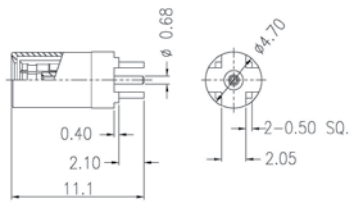

Aliner P/N	Impedance	Plating	Packaging	Mounting Pattern	Note
22-003C0-T	50	Gold	Tray	B02	Standard

Right Angle Jack(male contact)

PCB MOUNT

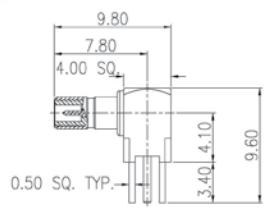

Aliner P/N	Impedance	Plating	Packaging	Mounting Pattern	Note
22-109BA-T	50	Gold	Tray	B02	Standard

Straight Jack(male contact)

PCB EDGE MOUNT

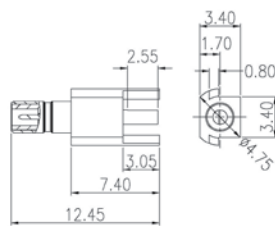

Aliner P/N	Impedance	Plating	Packaging	Mounting Pattern	Note
22-006A0-T	50	Gold	Tray	B51	Standard
22-006A0-R	50	Gold	Reel	B51	Standard

Straight Jack(male contact)

PCB EDGE MOUNT

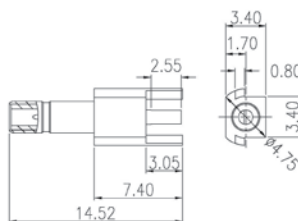

Aliner P/N	Impedance	Plating	Packaging	Mounting Pattern	Note
22-006B0-T	50	Gold	Tray	B51	Standard
22-006B0-B	50	Gold	Bulk	B51	Standard

Straight Plug(female contact)

SMD

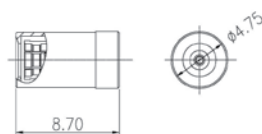

Aliner P/N	Impedance	Plating	Packaging	Mounting Pattern	Note
22-003D0-B	50	Gold	Bulk	B54	Standard

Straight Jack(male contact)

PCB EDGE MOUNT

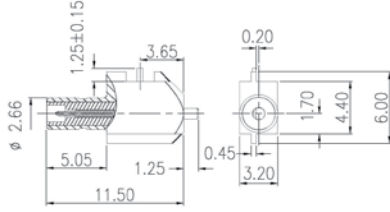

Aliner P/N	Impedance	Plating	Packaging	Mounting Pattern	Note
22-302A1-T	50	Gold	Tray	B72	Standard
22-302A1-R	50	Gold	Reel	B72	Standard

